

Narrow-style locks.



Narrow-style locks.



ASSA ABLOY

nemef.com

ASSA ABLOY, the global leader
in door opening solutions

Narrow-style locks.

Nemef guarantees an extensive and continually growing assortment of locks and builders' hardware, such as door locks, profile cylinders, multipoint locks and access control. These quality products that leave the Nemef plant reach their customers quickly and efficiently due to a hypermodern distribution centre in the Netherlands. Nemef is working today on the standard for tomorrow through innovative product development focused on contemporary user convenience.

Narrow-style locks of Nemef

The Nemef narrow-style locks series is especially developed for the commercial and residential lock market for application in aluminium, PVC or steel doors. Nemef narrow-style locks meet the highest demands in the field of material and design.

Advantages at a glance

- All versions have the same case dimensions. This means that all doors have the same cut-out.
- The series has an easy reversible latch bolt.
- The locks are maintenance free through thermally stable lubrication.
- The interior parts are zinc-plated and wear-resistant and therefore guarantee a long life.
- The lock cases are made of high graded steel and treated against corrosion.
- The lock cases are equipped with patent holes for security furniture.
- Forend 24 mm x 245 mm square stainless steel.
- The versions with rollerbolt are suitable for shop doors and similar. The door can be opened without using the lever.
- The 9600 series is equipped with die-cast bright nickel-plated bolts.

Fire-resistant

Possibility to have a fire-resistant MPA certified version in sash and panic function.

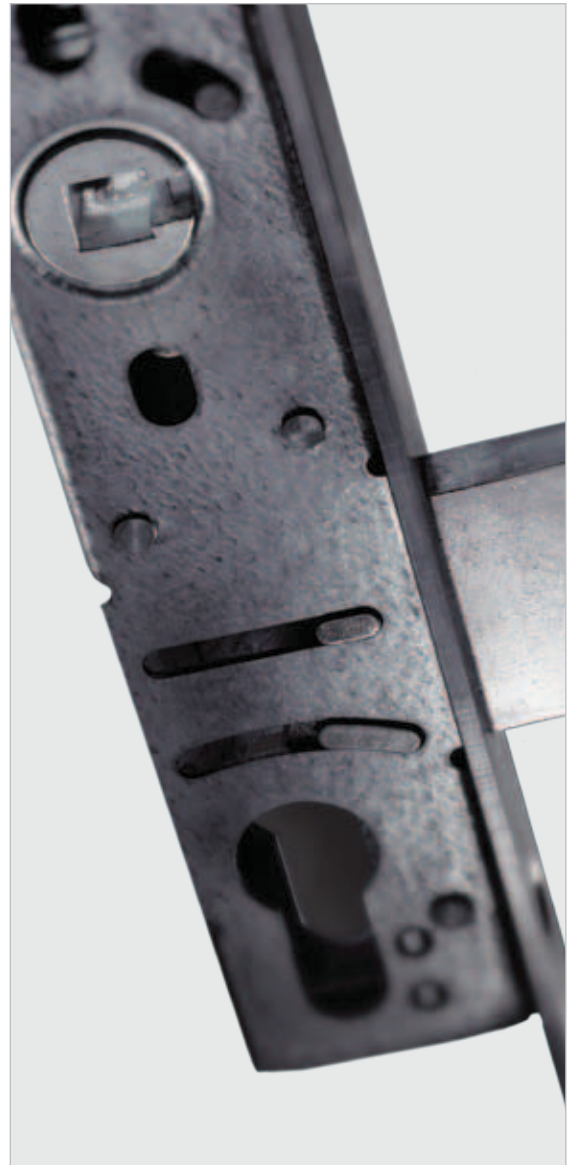

Narrow-style locks.

Information	Information about locks	Page 4
EN Standards	Overview of the European standards for building hardware	5
9600 Series	Narrow-style sash lock	11
9620 Series	Narrow-style latch	12
9630 Series	Narrow-style night latch	13
9640 Series	Narrow-style dead lock (small case)	14
9650 Series	Narrow-style dead lock (large case)	15
9660 Series	Narrow-style dead lock with pivot dead bolt	16
9670 Series	Narrow-style panic lock	17
9680 Series	Narrow-style roller bolt lock	18
9690 Series	Narrow-style hook bolt lock with security pin	19
Strike plates	Strike plates	20
Article coding 9600 Series	Article coding 9600 Series	21
Certificates 9600 and 9670 Series	Certificates 9600 and 9670 Series	22
Certificates ISO 9001 and EN 179	Certificates ISO 9001 and EN 179	23

Information about locks.

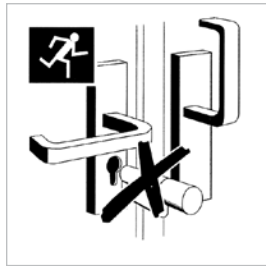

Do not fix a knob profile cylinder in lock of panic doors.



Do not paint front, dead- and latch bolt.



Do not leave a key in the lock of panic locks.



Do not drill through lockcases.



Do not fit the square spindle with force.

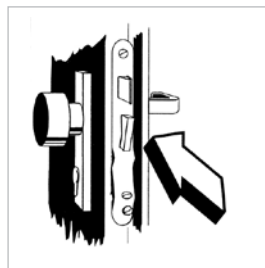

If door furniture is not fixed do not throw dead bolt. Locks must be replaced when signs of damage are obvious.

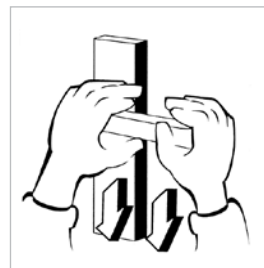

Do not force door trim.

International Situation Symbols

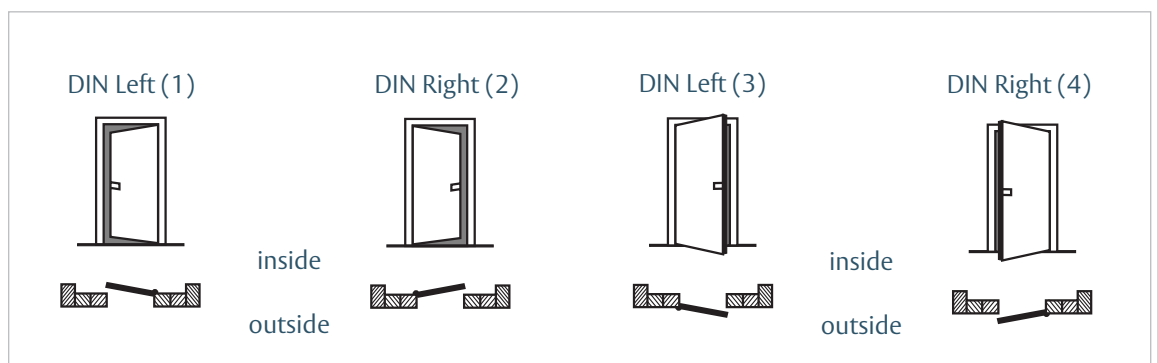

Overview of the European EN Standards for building hardware.

What are the advantages of an EN-tested product?

- Resistance/reliability.
- Durability.
- Safety.
- Ease-of-use.
- Guaranteed operability.
- Dimensions.
- Mechanical resistance.

Where do the standards apply?

- In public buildings
- Hospital.
 - Shopping centre.
 - Station.
 - Airport.

- In private buildings
- Apartment block.
 - Office.

EN 179

- Emergency exit devices operated by a lever handle or push pad, for use on escape routes.
- Requirements and test methods.

EN 1125

- Panic exit devices operated by a horizontal bar, for use on escape routes.
- Requirements and test methods.

EN 12209

- Locks and latches.
- Mechanically operated locks, latches and locking plates.
- Requirements and test methods.

CE marking

Mechanically operated locks, latches and panic and emergency exit devices intended for use on fire/ smoke control doors within the European Economic Area are covered by Construction Products Directive mandate issued by the European Commission. Consequently, this standard is regarded as “harmonised” and compliance with it, supported by suitable evidence, allows for the application of the CE mark.



EN 179 Emergency exit devices operated by a lever handle or push pad, for use on escape routes - Requirements and test methods.

Use

Emergency situations where the occupants know the building, its escape routes and emergency exits and where panic situations are hardly to be expected; for example, in offices or apartment blocks.

The emergency exit devices in accordance with standard EN 179 are intended to ensure a safe and efficient escape route via an emergency exit door that can be opened with one simple action.

Specifications for the locking mechanism for emergency exits in accordance with the EN 179 standard

- Operation tested between -10°C and $+60^{\circ}\text{C}$.
- U-shaped lever on the inside in order to minimise the risk of injury, and a minimum length of 120 mm (measured from the centre of the lever pivot pin to the extreme edge of the lever).
- Protrusion of the operating element:
 - maximum of 150 mm in category 1.
 - maximum of 100 mm in category 2.
- The exterior means of operation (key, cylinder, lever handle or knob) must be approved by the manufacturer of the emergency exit device.
- The force required to unlock an emergency exit device with a lever handle \Rightarrow less than 70 N.
- The force required to unlock an emergency exit device with a push pad (also known as pushing force) \Rightarrow less than 150 N.
- Durability:
 - 100,000 test cycles for grade 6.
 - 200,000 test cycles for grade 7.

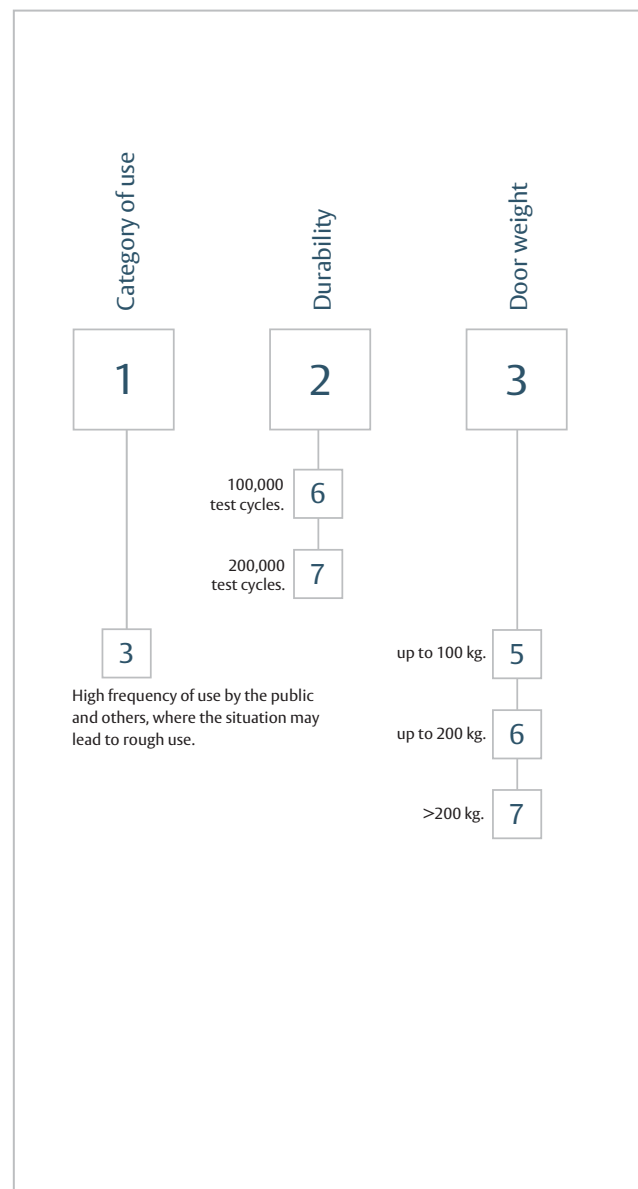

Classification EN 179: 2008.

Classification The EN 179 standard uses a 10 digit code to classify the emergency exit facility.

Nemef products that comply with the EN 179 standard

- Mechanical locks with a panic function and automatic locking.
Lock types: e.g. 9670 Series.

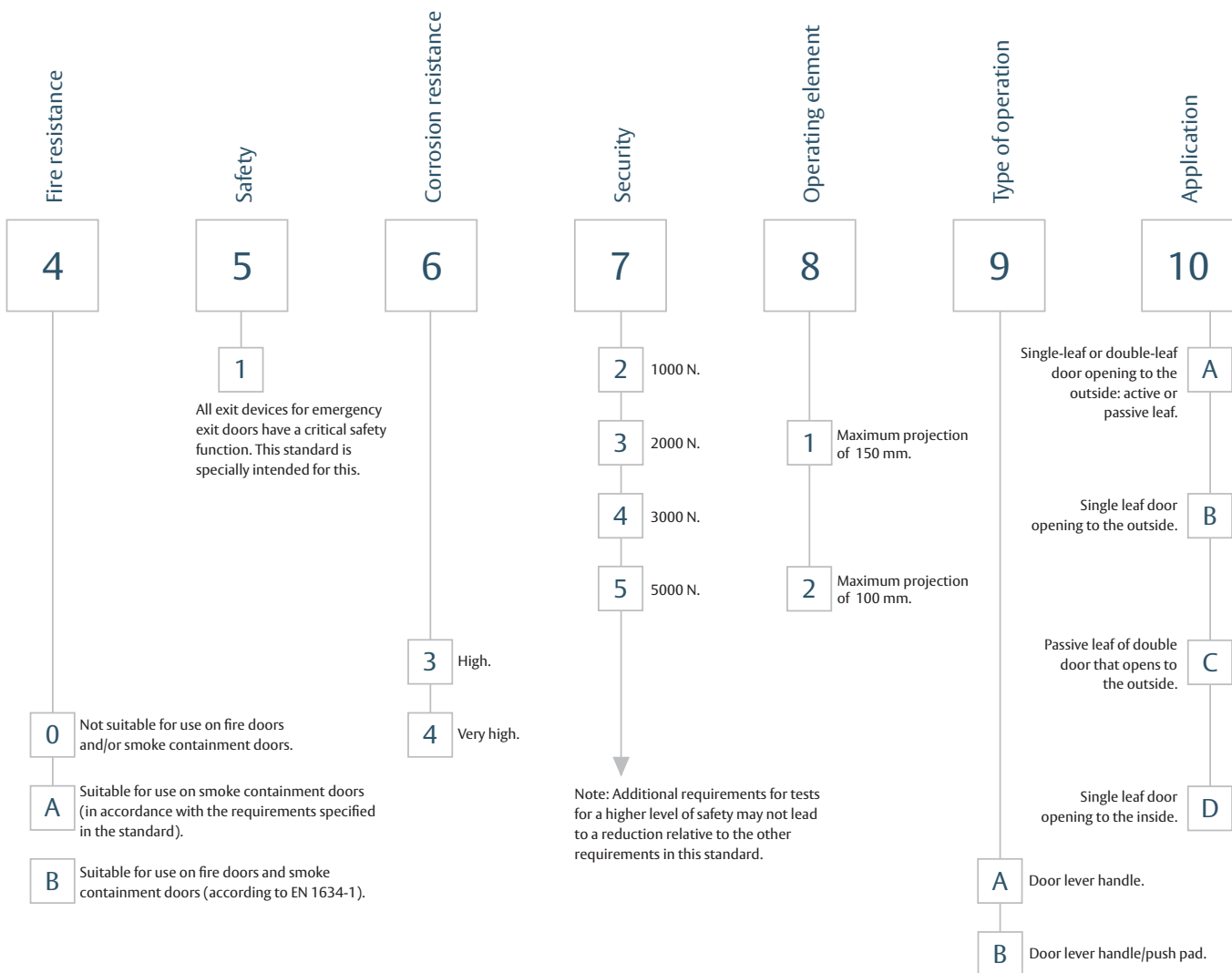

EN 12209 Locks and latches - Mechanically operated locks, latches and locking plates - Requirements and test methods.

Use

This European standard specifies the requirements and test methods for durability, resistance, security, operation of the mechanical locks and their locking plates in accordance with the usage profile for the door. The correct grade must be chosen in line with the usage profile.

Specifications for the locking mechanism for emergency exits in accordance with the EN 12209 standard.

- Operation tested between -20°C and +80°C.
- Category of use:
 - Grade 1: average frequency of use, very careful users => private use.
 - Grade 2: high frequency of use, careful users => interior doors in offices.
 - Grade 3: very high frequency of use, high probability of abuse => offices in public buildings.
- Durability: in accordance with the cycles and load on the day latch.
- Fire resistance:
 - Grade 0: not CF-approved.
 - Grade 1: CF-approved.
- Safety.
- Corrosion resistance.
- Security.

Classification

The EN 12209 standard uses an 11 digit code to classify the mechanical locks.

Nemef products that comply with the EN 12209 standard

Mechanical locks with a panic function and automatic locking.



Classification EN 12209:2003/AC:2005.

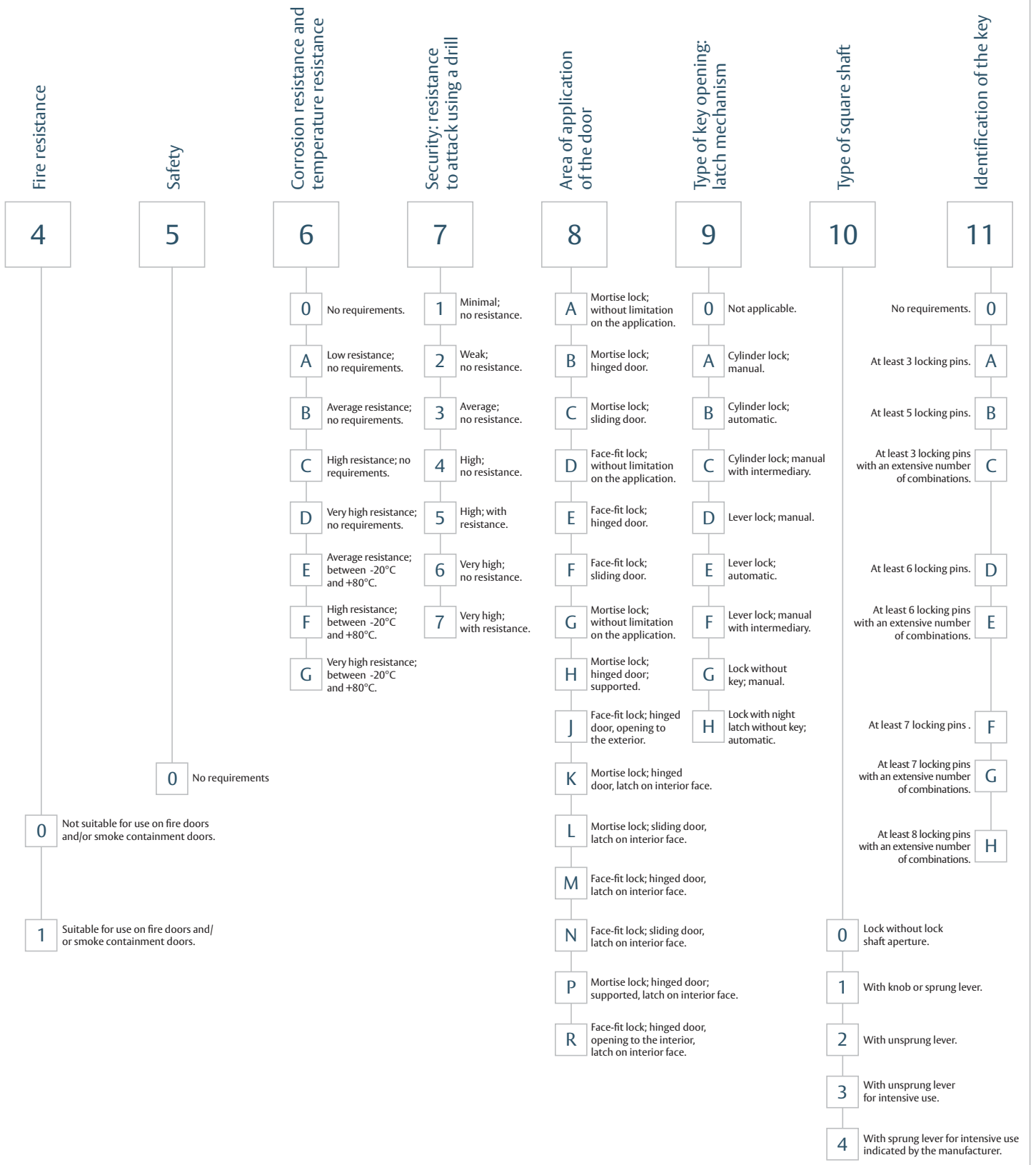



9600 Series.

Narrow-style sash lock.

Application	Suitable for inner doors and entrance doors.
Narrow-style sash lock 9600 Series	<ul style="list-style-type: none"> • For European profile cylinder. • Key action on latch bolt. • Single throw dead bolt. • Easy reversible latch bolt. • Backset 25, 30, 35, 40 and 45 mm. • Distance 92 mm. • U-forend on request. • Forend stainless steel. • Dead and latch bolt die-cast bright nickel-plated. • Without strike plate.
Fire-resistant	Also available in fire-resistant version, MPA certified, having a 9 mm special follower. Dead bolt is one throw 17 mm. Backset 30, 35 and 40 mm.
Accessories	Strike plate P9500/12 (zinc-plated) or P9600/17 (stainless steel) (page 20).

9600 Series



Certificate 9600

Classification no.												
Article	Specification	Designation according to EN 12209										
Nemef 96xx/08	Narrow style Lock with stainless steel forend 24 mm and sintered steel latch	2	X	8	1	0	F	2	H	A	3	0
Nemef 96xx all other types	Narrow style Lock with stainless steel forend 24 mm and Zamak latch	2	X	8	0	0	F	2	H	A	3	0

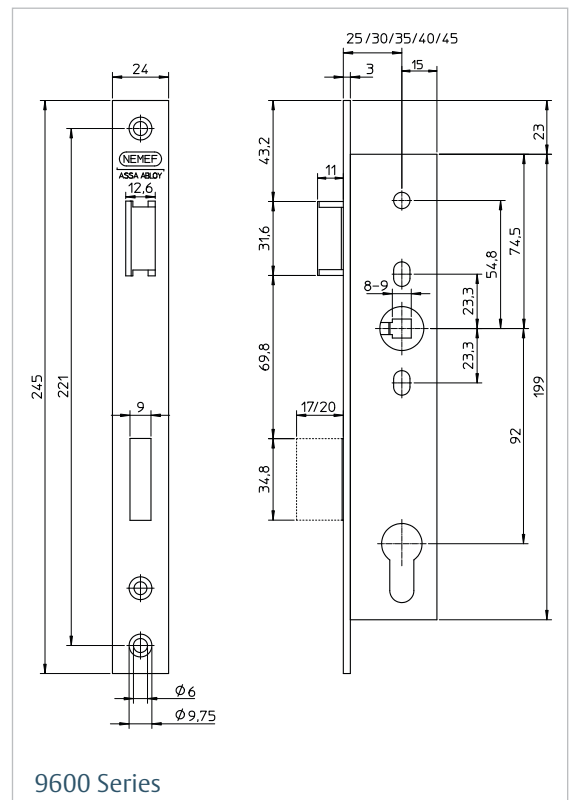

9620 Series. Narrow-style latch.

Application	Suitable for inner doors and entrance doors.
Narrow-style latch 9620 Series	<ul style="list-style-type: none"> • For European profile cylinder. • Easy reversible latch bolt. • Backset 25, 30, 35, 40 and 45 mm. • Forend stainless steel. • Latch bolt die-cast bright nickel-plated. • Without strike plate.
Accessories	Strike plate P635/12 (zinc-plated) or P635/17 (stainless steel) (page 20).

9620 Series



Standards: CE Marking, EN 12209

Certificate 9600

Classification no.		Designation according to EN 12209										
Article	Specification	2	X	8	1	0	F	2	H	A	3	0
Nemef 96xx/08	Narrow style Lock with stainless steel forend 24 mm and sintered steel latch	2	X	8	1	0	F	2	H	A	3	0
Nemef 96xx all other types	Narrow style Lock with stainless steel forend 24 mm and Zamak latch	2	X	8	0	0	F	2	H	A	3	0

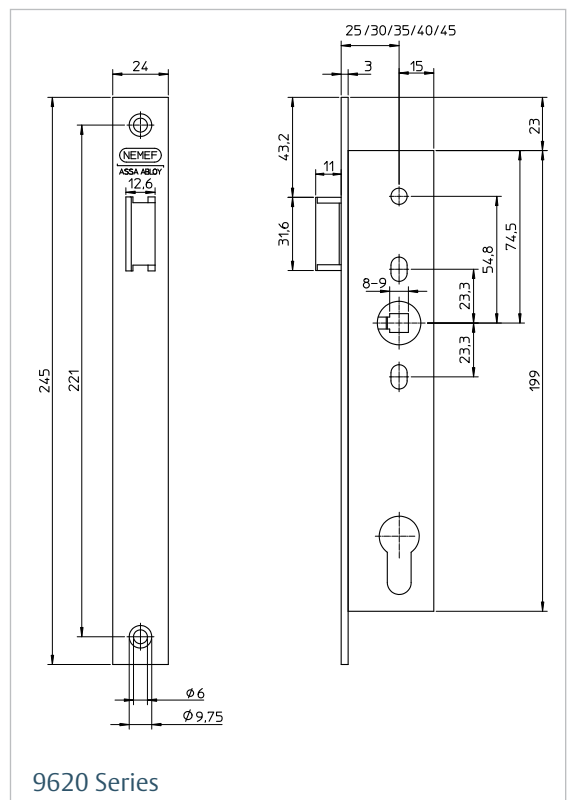

9620 Series

9640 Series.

Narrow-style dead lock (small case).

Application Suitable for inner doors and entrance doors.

Narrow-style dead lock (small case)
9640 Series

- For European profile cylinder.
- Single throw dead bolt.
- Non-handed.
- Backset 25, 30, 35, 40 and 45 mm.
- Forend stainless steel.
- Dead bolt die-cast bright nickel-plated.
- Without strike plate.

Accessories Strike plate P636/12 (zinc-plated) or P636/17 (stainless steel) (page 20).

9640 Series



Standards: CE Marking, EN 12209

Certificate 9600

Classification no.		Designation according to EN 12209										
Article	Specification	2	X	8	1	0	F	2	H	A	3	0
Nemef 96xx/08	Narrow style Lock with stainless steel forend 24 mm and sintered steel latch	2	X	8	1	0	F	2	H	A	3	0
Nemef 96xx all other types	Narrow style Lock with stainless steel forend 24 mm and Zamak latch	2	X	8	0	0	F	2	H	A	3	0

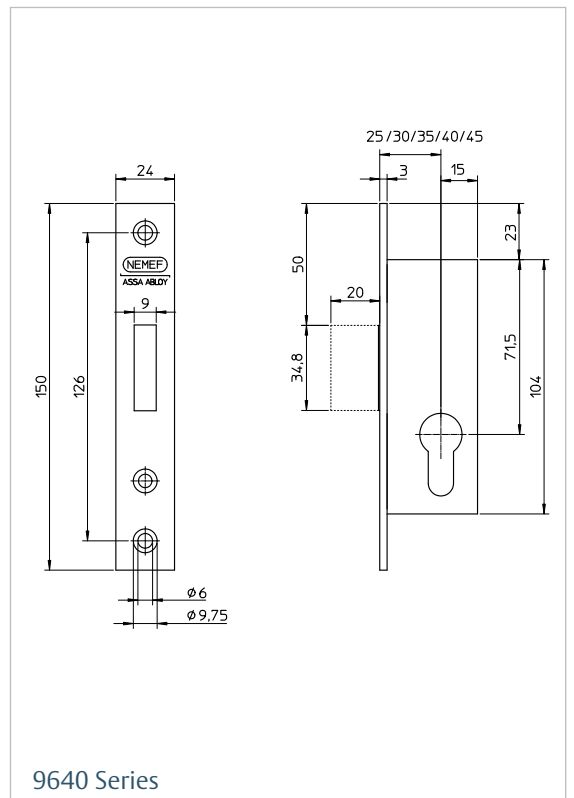

9640 Series

9650 Series.

Narrow-style dead lock (large case).

Application

Suitable for inner doors and entrance doors.

Narrow-style dead lock (large case) 9600 Series

- For European profile cylinder.
- Single throw dead bolt.
- Non-handed.
- Backset 25, 30, 35, 40 and 45 mm.
- Forend stainless steel.
- Dead bolt die-cast bright nickel-plated.
- Without strike plate.

Accessories

Strike plate P636/12 (zinc-plated) or P636/17 (stainless steel) (page 20).

9650 Series



Certificate 9600

Classification no.		Designation according to EN 12209										
Article	Specification	2	X	8	1	0	F	2	H	A	3	0
Nemef 96xx/08	Narrow style Lock with stainless steel forend 24 mm and sintered steel latch	2	X	8	1	0	F	2	H	A	3	0
Nemef 96xx all other types	Narrow style Lock with stainless steel forend 24 mm and Zamak latch	2	X	8	0	0	F	2	H	A	3	0

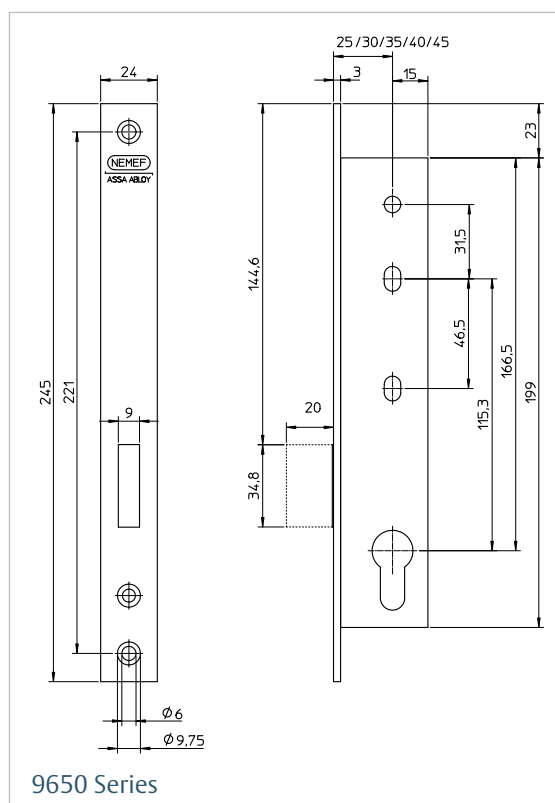

9660 Series.

Narrow-style dead lock with pivot dead bolt.

Application

Suitable for inner doors and entrance doors.

Narrow-style dead lock with pivot dead bolt
9660 Series

- For European profile cylinder.
- Key action on pivot dead bolt.
- Single throw.
- Non-handed.
- Backset 30, 35, 40 and 45 mm.
- Forend stainless steel.
- Pivot dead bolt steel, zinc-plated.
- Without strike plate.

Accessories

Strike plate P1205H/17 (stainless steel)
(page 20).

9660 Series



Standards: CE Marking, EN 12209

Certificate 9600

Classification no.		
Article	Specification	Designation according to EN 12209
Nemef 96xx/08	Narrow style Lock with stainless steel forend 24 mm and sintered steel latch	2 X 8 1 0 F 2 H A 3 0
Nemef 96xx all other types	Narrow style Lock with stainless steel forend 24 mm and Zamak latch	2 X 8 0 0 F 2 H A 3 0

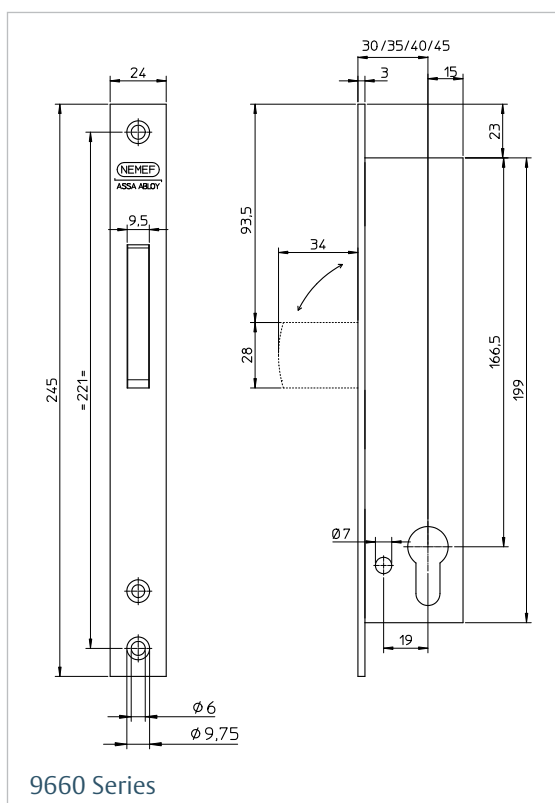

9660 Series

9670 Series.

Narrow-style panic lock.

Application

Suitable for inner doors and entrance doors.

Narrow-style panic lock 9670 Series

- For European profile cylinder.
- Key action on latch bolt.
- Single throw dead loft.
- Easy reversible latchbolt.
- Backset 30, 35, 40 and 45 mm.
- Distance 92 mm.
- With one-piece follower
- Two-piece follower (= handed).
- Forend stainless steel.
- Latch and dead bolt die-cast bright nickel-plated.
- Locks having 9 mm follower are fire-resistant, MPA certified.
- Without strike plate.

Accessories

Strike plate P9600/17 (stainless steel) (page 20).

9670 Series



Standards: CE marking, EN 12209 and EN 179

Certificate 9670

Classification no.		Designation according to EN 179								
Article	Specification	3	7	6	1	1	3	4	2	A
Nemef 9670/08	Narrow style Lock with stainless steel forend 24 mm and sintered steel latch	3	7	6	1	1	3	4	2	A
Nemef 9670 all other types	Narrow style Lock with stainless steel forend 24 mm and Zamak latch	3	7	6	0	1	3	4	2	A

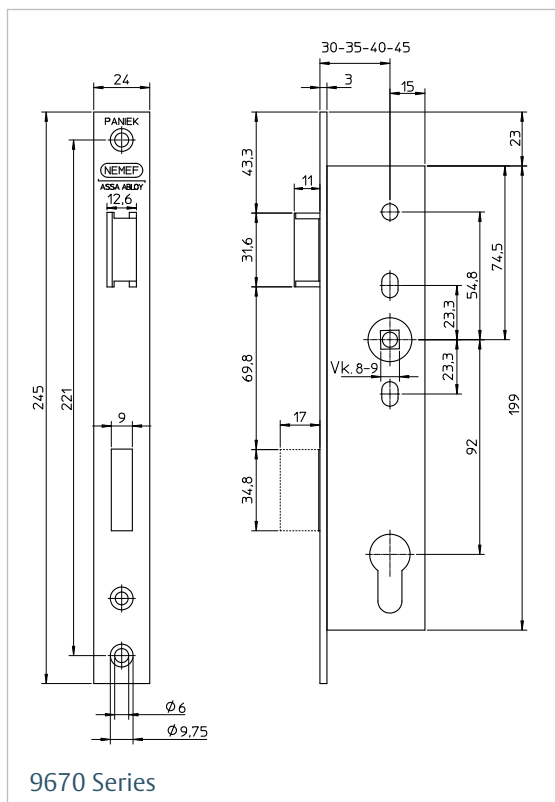

9670 Series

9680 Series.

Narrow-style roller bolt lock.

Application

Suitable for inner doors and entrance doors for the commercial market.

Narrow-style roller bolt lock 9680 Series

- For European profile cylinder.
- Key action on roller bolt.
- Single throw dead bolt.
- With adjustable brass nickel-plated roller bolt.
- Non-handed.
- Backset 25, 30, 35, 40 and 45 mm.
- Forend stainless steel.
- Roller bolt brass nickel-plated.
- Dead bolt die-cast bright nickel-plated.
- Without strike plate.

Accessories

None.

9680 Series



Certificate 9600

Classification no.		Designation according to EN 12209										
Article	Specification	2	X	8	1	0	F	2	H	A	3	0
Nemef 96xx/08	Narrow style Lock with stainless steel forend 24 mm and sintered steel latch	2	X	8	1	0	F	2	H	A	3	0
Nemef 96xx all other types	Narrow style Lock with stainless steel forend 24 mm and Zamak latch	2	X	8	0	0	F	2	H	A	3	0

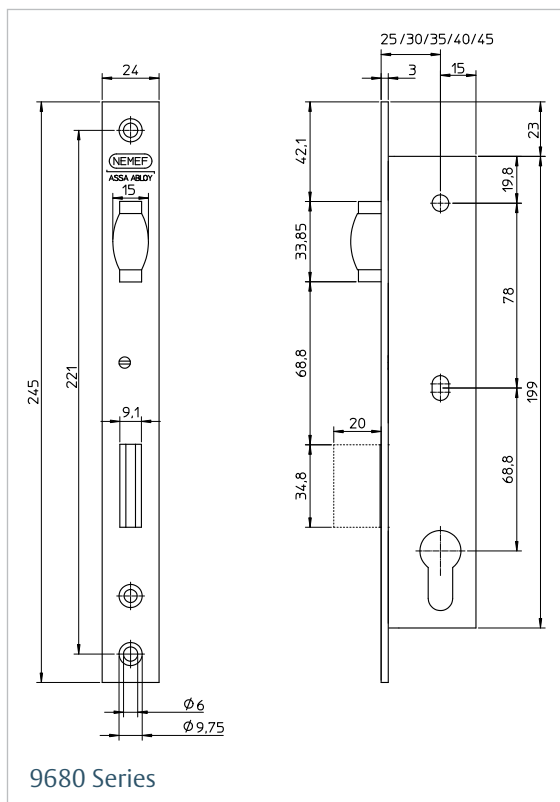

9690 Series.

Narrow-style hook bolt lock with security pin.

Application

Suitable for inner doors and entrance doors.

Narrow-style hook bolt lock with security pin
9690 Series

- For European profile cylinder.
- Key action on hook bolt.
- Single throw.
- Extra security pin which makes it impossible to lift the door.
- Non-handed.
- Backset 30, 35, 40 and 45 mm.
- Forend stainless steel.
- Hook bolt steel zinc-plated with security pin.
- Without strike plate.

Also available without security pin.

Accessories

Strike plate P1205H/17 (stainless steel) (page 20).

9690 Series



Standards: CE Marking, EN 12209

Certificate 9600

Classification no.		Designation according to EN 12209										
Article	Specification	2	X	8	1	0	F	2	H	A	3	0
Nemef 96xx/08	Narrow style Lock with stainless steel forend 24 mm and sintered steel latch	2	X	8	1	0	F	2	H	A	3	0
Nemef 96xx all other types	Narrow style Lock with stainless steel forend 24 mm and Zamak latch	2	X	8	0	0	F	2	H	A	3	0

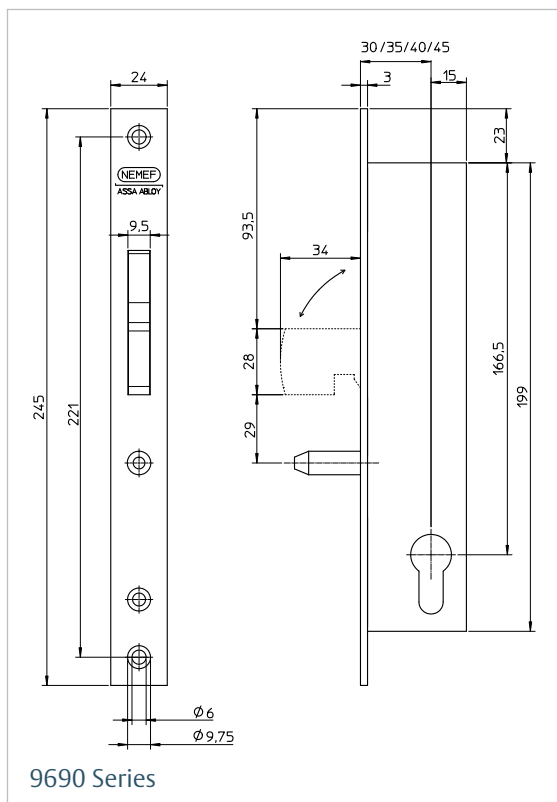

9690 Series

Strike plates.

Strike plates for 9620 and 9630 Series

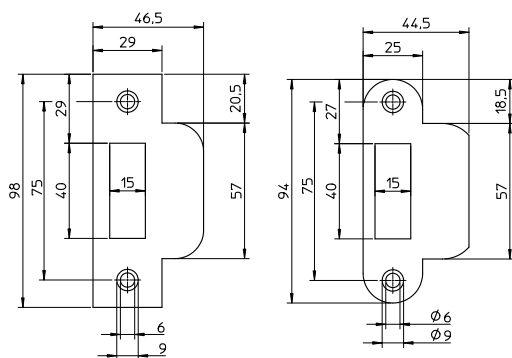

Art. P 635/12 or P 635/17

Strike plates for 9640 and 9650 Series

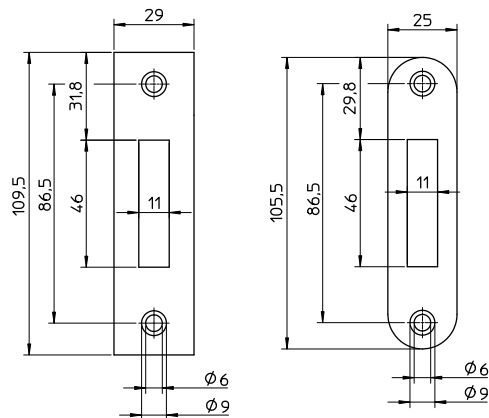

Art. P 636/12 or P 636/17

Strike plates for 9600 and 9670 Series

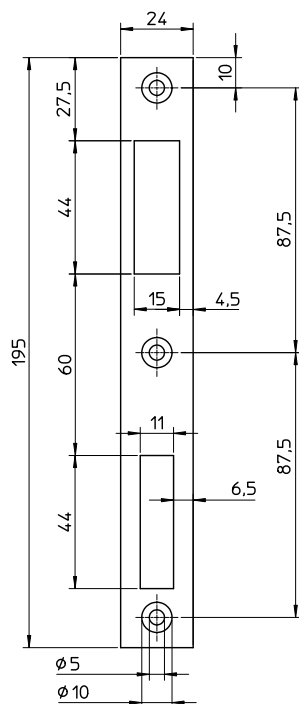

Art. P 9500/12 or P 9600/17

Strike plates for 9660 and 9690 Series

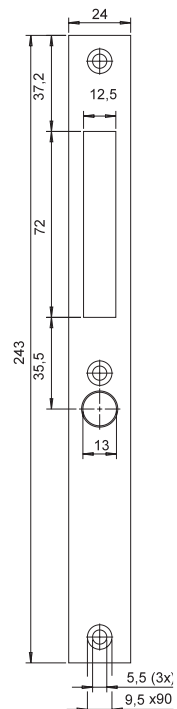

Art. P 1205H/17

Article coding 9600 Series.

Article coding

The article code for the 9600 Series consists of ten positions. In the table below a brief description of each position.

Position	Description	
1	9 always at the beginning	
2+3	96 code of series	
4	code of function	0 = sash 2 = latch 3 = night latch 4 = dead lock with small case 5 = dead lock with large case 6 = pivot dead bolt lock 7 = panic lock 8 = roller bolt lock 9 = hook bolt lock
5	code of backset	1 = 25mm 2 = 30mm 3 = 35mm 4 = 40mm 5 = 45 mm
6+7	code of hub	07 = 8 mm hub 08 = 9 mm hub
8+9	options – for example	10 = hook bolt lock 9690 without security pin 20 = splitted hub 30 = fire-resistant sash lock
10	handing	0 = non-handed 1 = DIN Left 2 = DIN Right

Example code 9967208201

Position	Description	
1	9 always at the beginning	
2+3	96 code of series	
4	code of function	7 = panic lock
5	code of backset	2 = 30mm
6+7	code of hub	08 = 9 mm hub
8+9	options	20 = splitted hub
10	handing	1 = DIN Left

This results in the article code 9967208201.

Certificates* 9600 and 9670 Series.

Certificate 9600 Series page 1

SKG Stichting Kwaliteit Gevelbouw **CE 0960**

Huisnummer 87 0211 - 42120
 8700 PA Wageningen 0217 - 42121
 Postbus 302 0218AJ Wageningen 0 - info@skg.nl
 8700 AJ Wageningen 1 - www.skg.nl

EC-CERTIFICATE OF CONFORMITY
0960 - CPD - 427.008

In compliance with the Directive 89/100/EEC of the Council of European Communities of 21 December 1989 on the approximation of laws, regulations and administrative provisions of the Member States relating to the construction products (Construction Products Directive - CPD), amended by the Directive 93/68/EEC of the Council of European Communities of 22 July 1993, it has been stated that the construction product:

Locks 9600 series
 as specified in attached appendix (1 page)
 produced and placed on the market by

Nemef B.V.
Papegaaiweg 35
Wenrum Wiesel

is submitted by the manufacturer to a factory production control (FPC) and the further testing of samples taken at the factory in accordance with a prescribed test plan and that the notified body - SKG - has performed the initial type-testing for the relevant characteristics of the product, the initial inspection of the factory and of the FPC and performs the continuous surveillance, assessment and approval of the FPC and an audit testing of samples taken at the factory, on the market or at the construction site.

This certificate attests that all provisions concerning the attestation of conformity and the performance described in Annex ZA of the standard

EN 12209:2003

were applied and that the product fulfils all the prescribed requirements.

This certificate was first issued on 11 May 2007 and remains valid as long as the conditions laid down in the harmonised technical specification in reference or the manufacturing conditions in the factory or the FPC itself are not modified significantly.

Wageningen, 11 May 2007

J. F.A. Zandstra
 Manager

This Certificate has 1 page and 1 appendix (1 page)

EN 12209

Certificate 9600 Series page 2

SKG Stichting Kwaliteit Gevelbouw **CE 0960**

Huisnummer 87 0211 - 42120
 8700 PA Wageningen 0217 - 42121
 Postbus 302 0218AJ Wageningen 0 - info@skg.nl
 8700 AJ Wageningen 1 - www.skg.nl

Appendix
EC-CERTIFICATE OF CONFORMITY 0960 - CPD - 427.010 issued 2007-08-11

Locks 9600 series
 produced and placed on the market by

Nemef B.V.
Papegaaiweg 35
Wenrum Wiesel

Article	Description	Designation according to EN 12209
NEMEF 9600-02	Nemef 9600 Lock with stainless steel frame 24 mm and polished steel 9600	2 4 2 4 2 4 2 4 2 4 2 4 2 4 2 4
NEMEF 9600 all other types	Nemef 9600 Lock with stainless steel frame with 24 mm and Zamac 9600	2 4 2 4 2 4 2 4 2 4 2 4 2 4 2 4

EN 12209

Certificate 9670 Series page 1

SKG Stichting Kwaliteit Gevelbouw **CE 0960**

Huisnummer 87 0211 - 42120
 8700 PA Wageningen 0217 - 42121
 Postbus 302 0218AJ Wageningen 0 - info@skg.nl
 8700 AJ Wageningen 1 - www.skg.nl

EC-CERTIFICATE OF CONFORMITY
0960 - CPD - 427.009

In compliance with the Directive 89/100/EEC of the Council of European Communities of 21 December 1989 on the approximation of laws, regulations and administrative provisions of the Member States relating to the construction products (Construction Products Directive - CPD), amended by the Directive 93/68/EEC of the Council of European Communities of 22 July 1993, it has been stated that the construction product:

Locks 9670 series
 as specified in attached appendix (1 page)
 produced and placed on the market by

Nemef B.V.
Papegaaiweg 35
Wenrum Wiesel
The Netherlands

is submitted by the manufacturer to a factory production control (FPC) and the further testing of samples taken at the factory in accordance with a prescribed test plan and that the notified body - SKG - has performed the initial type-testing for the relevant characteristics of the product, the initial inspection of the factory and of the FPC and performs the continuous surveillance, assessment and approval of the FPC and an audit testing of samples taken at the factory, on the market or at the construction site.

This certificate attests that all provisions concerning the attestation of conformity and the performance described in Annex ZA of the standard

EN 179: 1997/A1 :2001/AC :2002

were applied and that the product fulfils all the prescribed requirements.

This certificate was first issued on 7 July 2007 and remains valid as long as the conditions laid down in the harmonised technical specification in reference or the manufacturing conditions in the factory or the FPC itself are not modified significantly.

Wageningen, 10 July 2007

J. F.A. Zandstra
 Manager

This Certificate has 1 page and 1 appendix (1 page)

EN 179

Certificate 9670 Series page 2

SKG Stichting Kwaliteit Gevelbouw **CE 0960**

Huisnummer 87 0211 - 42120
 8700 PA Wageningen 0217 - 42121
 Postbus 302 0218AJ Wageningen 0 - info@skg.nl
 8700 AJ Wageningen 1 - www.skg.nl

Appendix 1 - page 1
EC-CERTIFICATE OF CONFORMITY 0960 - CPD - 427.008 issued 2007-07-18

Locks 9670 series
 produced and placed on the market by

Papegaaiweg 35
Wenrum Wiesel
The Netherlands
Nemef B.V.

Article	Description	Designation according to EN 179
NEMEF 9670-02	Locks 9670 series with stainless steel frame 24 mm with stainless steel and in combination with stainless security furniture (Type 9670)	2 4 2 4 2 4 2 4 2 4 2 4 2 4 2 4
NEMEF 9670 all other types	Locks 9670 series with stainless steel frame 24 mm with enamel and zamac with and gold in combination with stainless security furniture (Type 9670)	2 4 2 4 2 4 2 4 2 4 2 4 2 4 2 4

EN 179

* Certificates can be downloaded from our website www.nemef.com.

Certificates*

ISO 9001 and EN 179.

If you require more information about the certificates or the combination of different locks with panic exit devices, please contact us.

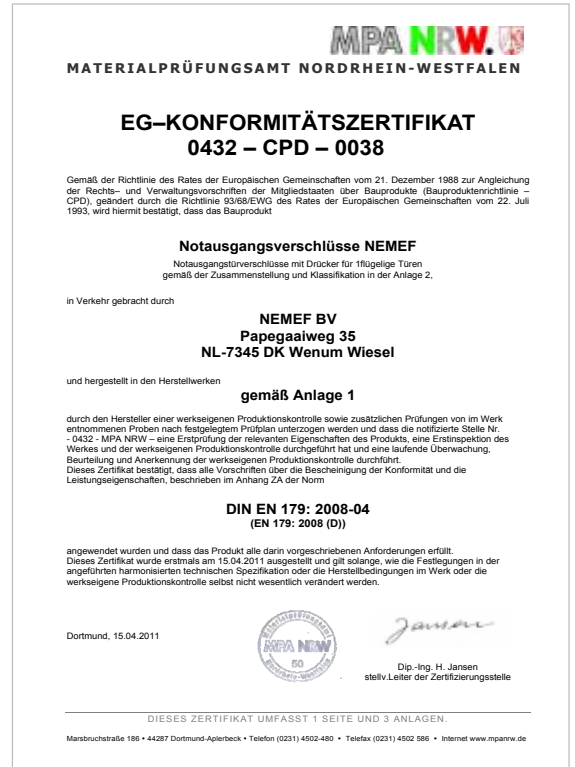

* Certificates can be downloaded from our website www.nemef.com.

ASSA ABLOY is the global leader in door opening solutions, dedicated to satisfying end-user needs for security, safety and convenience.



ASSA ABLOY

ASSA ABLOY Nederland B.V.
Business Unit Nemef
P.O. Box 13
7300 AA Apeldoorn
The Netherlands
Tel. +31 88 6394800
Fax +31 88 6394928
export@nemef.nl
www.nemef.com